



28 Kernham Drive

Tilehurst, RG31 6GB

Guide price £475,000 Freehold



VP - NO ONWARD CHAIN. This charming three bedroom link-detached house offers a perfect blend of comfort and convenience. Upon entering, you are greeted by a welcoming entrance hallway that leads to a well-appointed WC, ensuring practicality for family living. The heart of the home is the spacious living/dining kitchen area, ideal for both entertaining guests and enjoying family meals. Adjacent to this space is a delightful sunroom, providing a bright and airy atmosphere, perfect for relaxation or enjoying the garden views.

The first floor boasts three generously sized bedrooms, each offering ample space for personalisation. A well-designed bathroom suite serves this level, catering to the needs of the household with ease.

Externally, the property features off-road parking, along with a garage, providing additional storage or parking options. The enclosed rear garden is a wonderful outdoor space, perfect for children to play or for hosting summer gatherings.

This property is not only a lovely family home but also benefits from its proximity to local amenities, schools, and transport links, making it an ideal choice for those seeking a vibrant community. With its appealing features and practical layout.

Council tax band - D

- NO ONWARD CHAIN
- THREE BEDROOMS
- SUN ROOM
- DOWNSTAIRS WC
- GARAGE
- CUL DE SAC LOCATION
- LINK DETACHED HOUSE
- OFF ROAD PARKING

Get Social

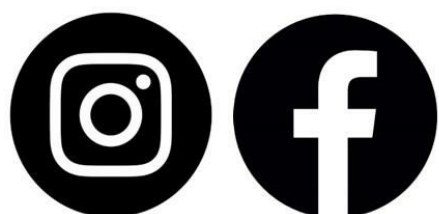

VillageProperties.co.uk



Ground Floor

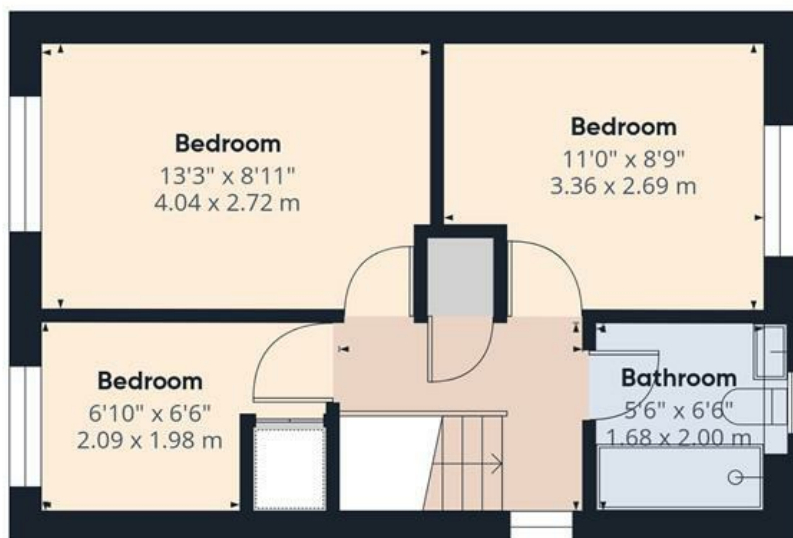

Floor 1



Approximate total area^m
976 ft²
90.7 m²

(1) Excluding balconies and terraces

Calculations reference the RICS IPMS 3C standard. Measurements are approximate and not to scale. This floor plan is intended for illustration only.

GIRAFFE360

