



10 Sheppard Court
Tilehurst, RG31 5JF



Guide price £100,000 Leasehold

VillageProperties.co.uk

10 Sheppard Court Chieveley Close

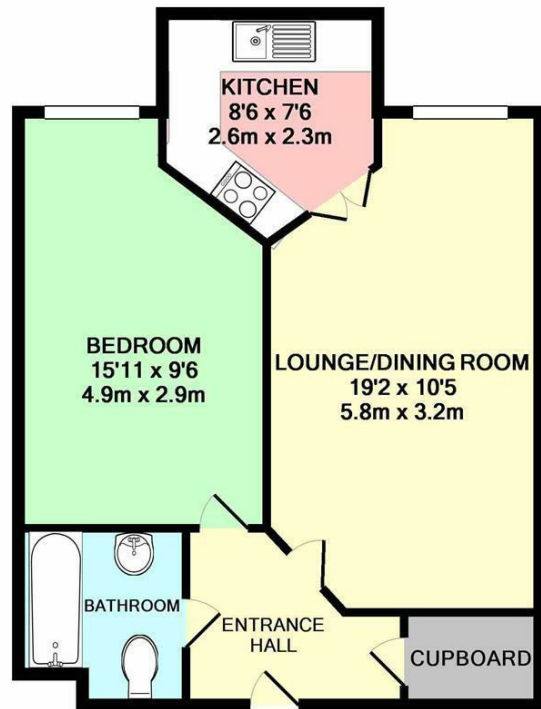

TOTAL APPROX. FLOOR AREA 480 SQ.FT. (44.6 SQ.M.)

Whilst every attempt has been made to ensure the accuracy of the floor plan contained here, measurements of doors, windows, rooms and any other items are approximate and no responsibility is taken for any error, omission, or mis-statement. This plan is for illustrative purposes only and should be used as such by any prospective purchaser. The services, systems and appliances shown have not been tested and no guarantee as to their operability or efficiency can be given
Made with Metropix ©2019

Get Social



DESCRIPTION:

VP - Presented to the market is this well presented apartment situated within easy access of Tilehurst village centre. Built by McCarthy stone, Sheppard Court is set within well kept communal grounds with parking. The building is serviced by a lift and can be accessed from Park Lane or Chieveley Close. The accommodation offers security entrance phone to communal hall, stairs or lift to upper ground floor, entrance hall, lounge, bedroom with built in wardrobe, bathroom, kitchen and views over the communal garden from the lounge and kitchen.

SUMMARY OF ACCOMMODATION:

- NO ONWARD CHAIN
- WALKING DISTANCE TO TILEHURST VILLAGE CENTRE
- LIVING/DINING ROOM
- 1 DOUBLE BEDROOM
- OVER 55'S

ADDITIONAL INFO:

Local Authority: Reading Borough Council
Tax Band: C
Service charge £3007.48 - Annually
Ground rent is £385 - Annually
110yrs left on lease
Approx. Distances:
Tilehurst Railway Station: 1.2 miles
M4 motorway (J12): 2.0 Miles

VIEWING STRICTLY BY APPOINTMENT:

T: 0118 941 5607
E: sales@villageproperties.org
W: www.villageproperties.co.uk

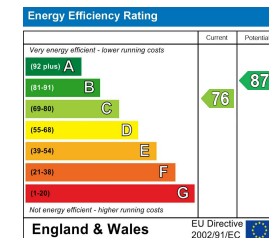

92 School Road
Reading
RG31 5AU