



6A High Street
Twyford, RG10 9AE

£1,000 PCM

VillageProperties.co.uk

6A High Street

GROUND FLOOR
480 sq.ft. (44.6 sq.m.) approx.

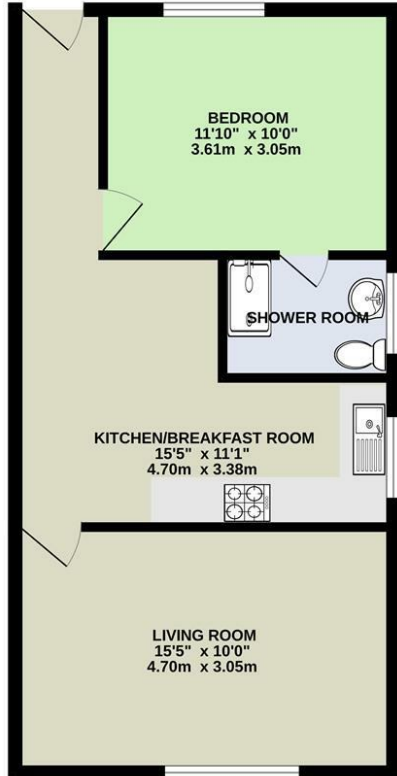

TOTAL FLOOR AREA : 480 sq.ft. (44.6 sq.m.) approx.
Whilst every attempt has been made to ensure the accuracy of the floorplan contained here, measurements of doors, windows, rooms and any other items are approximate and no responsibility is taken for any error, omission or mis-statement. This plan is for illustrative purposes only and should be used as such by any prospective purchaser. The services, systems and appliances shown have not been tested and no guarantee as to their operability or efficiency can be given.
Made with Metropix ©2023

DESCRIPTION:

VP – Available to let is this fantastic 1 bedroom, first floor maisonette in the heart of Twyford. The property benefits from all the fantastic local amenities including Waitrose superstore, restaurants, hairdressers, and coffee shops plus a short walk to Twyford train station (on the Elizabeth line).

The accommodation includes entrance hall, double bedroom, shower room, a large kitchen breakfast area and a front aspect living room.

SUMMARY OF ACCOMMODATION:

- AVAILABLE IN JUNE 2023
- CLOSE TO TRAIN STATION
- LARGE KITCHEN/BREAKFAST ROOM
- CENTRE OF TWYFORD
- DOUBLE BEDROOM
- PARKING

ADDITIONAL INFO:

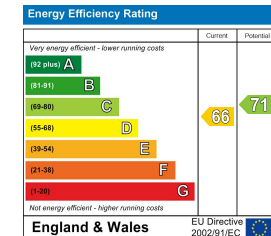

VIEWING STRICTLY BY APPOINTMENT:

T: 0118 941 5607
E: sales@villageproperties.org
W: www.villageproperties.co.uk

92 School Road
Reading
RG31 5AU

Get Social

