



3 Dalton Close
Tilehurst, RG30 4XH



Guide price £285,000 Freehold

VillageProperties.co.uk

3 Dalton Close

GROUND FLOOR
392 sq.ft. (36.4 sq.m.) approx.

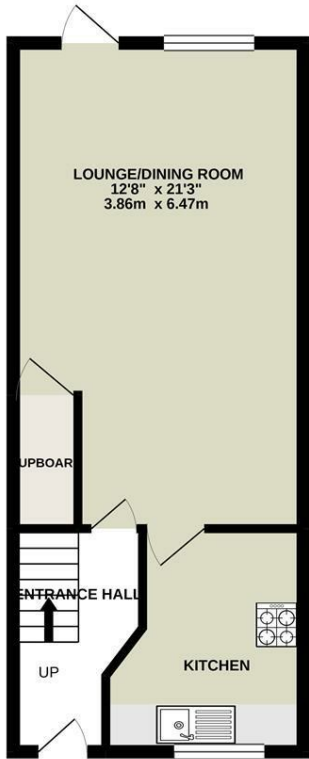

1ST FLOOR
392 sq.ft. (36.4 sq.m.) approx.

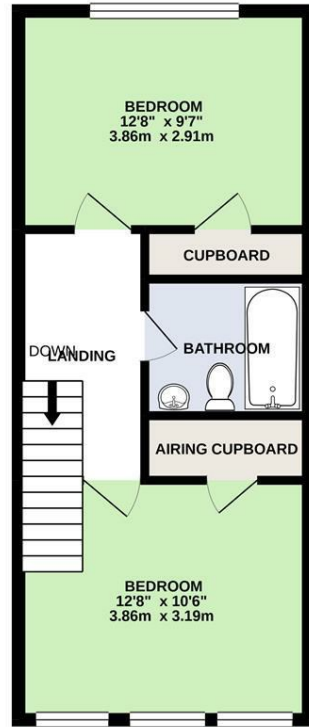

TOTAL FLOOR AREA - 785 sq.ft. (72.9 sq.m.) approx.
Whilst every attempt has been made to ensure the accuracy of the floorplan contained here, measurements of doors, windows, rooms and any other items are approximate and no responsibility is taken for any error, omission or mis-statement. This plan is for illustrative purposes only and should be used as such by any prospective purchaser. The services, systems and appliances shown have not been tested and no guarantee as to their operability or efficiency can be given.
Made with Metropix 6.5.021

DESCRIPTION:

VP - NO ONWARD CHAIN. Presented to the market is this two double bedroom terrace house located in a cul de sac and within easy access to Tilehurst Village centre, bus routes, schools and Tilehurst station. The property comprises living/dining room, kitchen, two double bedrooms and bathroom. The rear garden is enclosed with a lawn and patio area, there is a rear access gate leading you to the garage nearby.

SUMMARY OF ACCOMMODATION:

- CUL DE SAC
- TWO DOUBLE BEDROOMS
- NO ONWARD CHAIN
- GARAGE
- GAS CENTRAL HEATING
- CLOSE TO TILEHURST CENTRE

ADDITIONAL INFO:

Energy Efficiency Rating		
	Current	Potential
Very energy efficient - lower running costs		
(92 plus) A		
(81-91) B		
(69-80) C		
(55-68) D		
(39-54) E		
(21-38) F		
(1-20) G		
Not energy efficient - higher running costs		
England & Wales	EU Directive 2002/91/EC	

VIEWING STRICTLY BY APPOINTMENT:

T: 0118 941 5607
E: sales@villageproperties.org
W: www.villageproperties.co.uk

92 School Road
Reading
RG31 5AU

Get Social

